



UPPER

Water-repellent and breathable polyester jacquard fabric. Cut resistant, anti-fraying, rip and abrasion resistant. *Anti-abrasion scuff-cap and ATOP quick closure system.*

LINING

PLASMAFEEL Lining in 3D fabric that keeps the foot constantly cool and dry thanks to the instantaneous absorption of sweat and its immediate dispersion outside of the shoe. Breathable, antibacterial, resistant to wear and abrasion.

INSOLE

TECHSOFT Thermoformed. Runproof, multi-layered, antistatic latex-foam fabric, that is antibacterial, breathable and absorbent with anti-fungus activated carbons. Shock absorbing heel and plantar arch support.

SOLE

PU / TPU BASF PUR Elastopan® polyurethane foam insole, ensures the maximum comfort and the absorption of the impact on all surfaces. Bi-colored TPU outsole, with an elevated grip, resistant to wear, oils and hydrocarbons. System of energy absorption on the heel.

LAST

ANATOMIC SOLE The anatomical shape of the injected sole, unlike removable insoles, is inalterable for the entire lifetime of the shoe. The Anatomic sole, following the natural morphology of the foot, provides a natural support to all its points, ensuring maximum comfort

TOE CAP

POWER CAP is in multilayer fiberglass and rubber particulate. It stands out for its robustness and lightness, guaranteeing a shock absorption up to a max. 200 Joules. Being metal-free is undetectable by a meta detector, and helps to maintain a constant body temperature. It provides maximum safety even at extreme temperatures above and below zero, providing a thermal insulation that is better than aluminum or steel toe-caps. It is compliant with CSA Canada regulations and exceeds the EN-ISO12568 requirements.

MIDSOLE

TEXON ENIGMA ZERO HT2 Non-metallic antistatic, flexible, anti-perforation fabric insole, built with several layers of high-tenacity fibres. It ensures perfect thermal insulation Compliant with: EN 12568:2012; EN ISO 20344/345; CSA-Z195-14; ASTM F2413-18

ANTI-TORSION SUPPORT

COMPOSHANK Anti-torsion rigid ABS support. It is applied between the anti-perforation midsole and midsole, at the arch of the foot. It improves stability on stairs, where the support of the foot is not ideal

ANTI-STATIC DEVICE

SILVER STRIP DISCHARGE (SSD) Conductive cotton tape with silver threads, positioned inside the upper and in direct contact with the foot. It is an extra Anti-static device, increasing and stabilizing the dispersive capacity throughout the life of the shoe.

WEIGHT SIZE 42 580 gr

SIZE 35-49

TECH SOFT



FEATURES

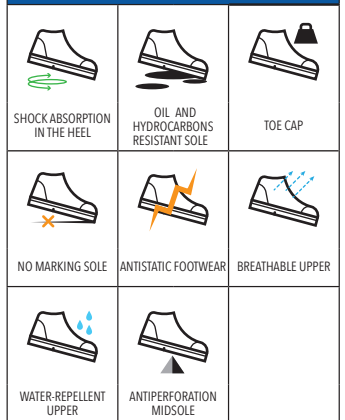

PLUS



TECHNOLOGIES

