

# Getting started with Logitech® Wireless Headset H600

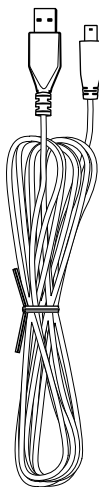

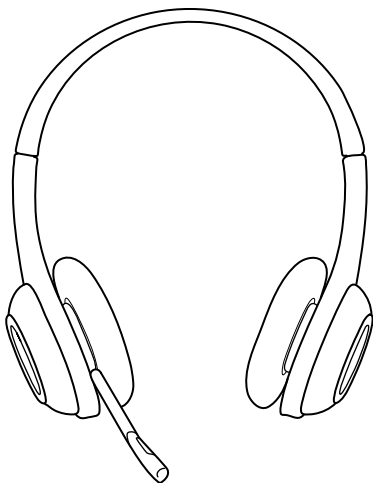

## Headset features

1. Noise-canceling microphone
2. Flexible, rotating microphone boom
3. Adjustable headband
4. Charging port
5. Status light
6. Nano receiver storage
7. Volume up
8. Volume down
9. Power switch
10. Microphone mute
11. USB wireless Nano receiver
12. USB charging cable

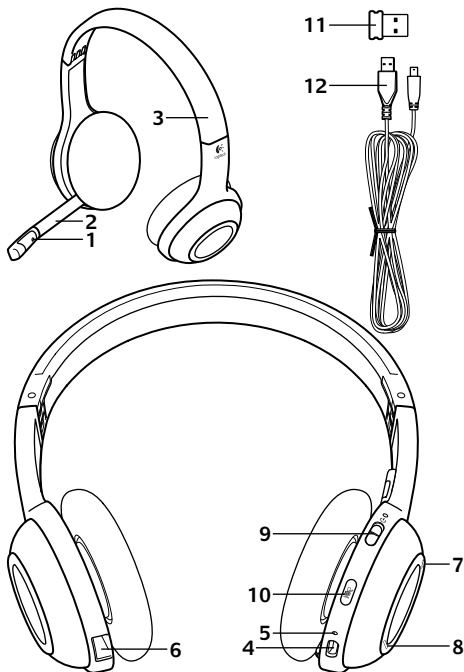

1



2

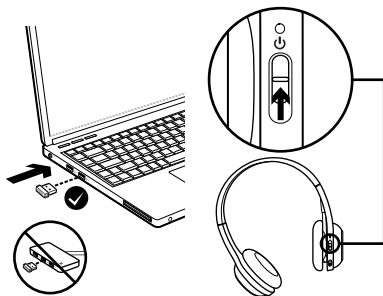

3

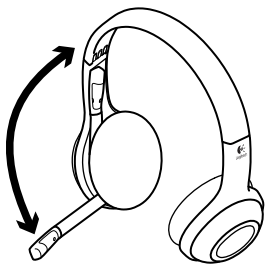
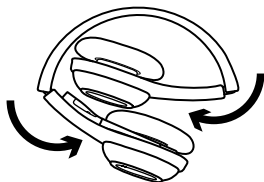

# 4

## Try the headset

Listen to music or make an Internet call to test the wireless connection between the headset and your audio source (laptop or smartphone). If the headset doesn't work with your computer, you may need to make an adjustment in your computer's operation system so it will recognize the headset, making the headset the default audio input/output device. Also refer to Help with setup for additional troubleshooting advice.

### **Windows® XP**

1. Go to Start/Control Panel/Sounds and Audio devices/Audio tab.
2. In the Sound Playback/Default Device window, choose the Logitech Wireless Headset H600.
3. Select the Voice tab.
4. In the Voice tab, choose the Logitech Wireless Headset H600.
5. Click OK.
6. Restart your media application.

### **Windows® Vista and Windows® 7**

1. Go to Start/Control Panel/Sounds/Playback Devices tab.
2. Choose Playback Devices.
3. Choose the Logitech Wireless Headset H600.
4. Click Set Default, and then click OK.
5. Select the Recording Tab.
6. Choose the Logitech Wireless Headset H600.
7. Click Set Default, and then click OK.
8. Restart your media application.

### **Mac® OS**

1. Open System Preferences.
2. Choose the Sound/Output tab.
3. Choose the Logitech Wireless Headset H600.
4. Select the Input tab.
5. Choose the Logitech Wireless Headset H600.
6. Close window.
7. Restart your media application.

## Status light indicators

Color/behavior	Meaning
Green	More than 30 minutes of battery life left
Red (+ beeping)	Less than 30 minutes of battery life left
Orange	Charging
Steady	Wireless connected and ready to use
Blinking	Wireless not connected
Pulsing	Headset is off and charging
Off	Headset is off

Note: To charge the headset, plug the included USB charging cable into your headset and computer. When the headset battery is very low, a full charge can take up to three hours. But you don't have to stop using the headset because it charges while you talk or listen to music.

Important: At product end of life, the battery is removable for disposal/recycling ONLY. Please see [www.logitech.com/support](http://www.logitech.com/support) for more information.

## Help with setup

### Something not sound right? No sound at all? Not connecting?

- Try moving the headset closer to the USB wireless Nano receiver. The wireless connection status light on the headset turns solid green when the headset is in range (up to 30ft/10m) with the Nano receiver. See the wireless performance table below for Nano receiver placement tips.
- Make sure the headset is the active output audio device in both your application and operating system. For more information, see Test the Headset.
- Adjust the volume and microphone settings to an audible level in both your application and operating system.
- Quit and restart your media application.
- If you're using a USB hub (powered or un-powered), try plugging the Nano receiver directly into your computer.
- Try using the headset with another computer.

### Headset not charging?

- Use the provided USB charging cable. Connect the cable to the charging port on the headset, and connect the other end of the cable to a USB port on your computer.
- If you are using a USB hub, connect the charging cable directly to a USB port on your computer.

### Controls not working?

- Some functions of the headset may not be supported depending on the tablet, smartphone and/or application.

### Wireless performance

<b>Not recommended</b>	<b>Recommended</b>
Back of desktop tower	Front of desktop tower
Plugged into monitor or keyboard USB port	Directly plugged into the PC
USB hub (powered or non-powered)	Directly plugged into the PC
Right next to other receivers (laptop)	Away from other receivers (laptop)
Within three feet of wireless router	More than three feet away from a wireless router

For additional assistance, please visit [www.logitech.com/support](http://www.logitech.com/support).

## www.logitech.com/support



België/Belgique Dutch: +32-(0)2 200 64 44;  
French: +32-(0)2 200 64 40

Česká Republika +420 239 000 335

Danmark +45-38 32 31 20

Deutschland +49-(0)69-51 709 427

España +34-91-275 45 88

France +33-(0)1-57 32 32 71

Ireland +353-(0)1 524 50 80

Italia +39-02-91 48 30 31

Magyarország +36 (1) 777-4853

Nederland +31-(0)-20-200 84 33

Norge +47-(0)24 159 579

Österreich +43-(0)1 206 091 026

Polska 00800 441 17 19

Portugal +351-21-415 90 16

Россия +7(495) 641 34 60

Schweiz/Suisse D +41-(0)22 761 40 12

Svizzera F +41-(0)22 761 40 16

I +41-(0)22 761 40 20

E +41-(0)22 761 40 25

South Africa 0800 981 089

Suomi +358-(0)9 725 191 08

Sverige +46-(0)8-501 632 83

Türkiye 00800 44 882 5862

United Arab Emirates 8000 441-4294

United Kingdom +44-(0)203-024-81 59

European, English: +41-(0)22 761 40 25  
Mid. East., & Fax: +41-(0)21 863 54 02  
African Hq.

Morges,  
Switzerland

Eastern Europe English: 41-(0)22 761 40 25

United States +1 646-454-3200

Argentina +0800 555 3284

Brasil +0800 891 4173

Canada +1-866-934-5644

Chile +1230 020 5484

Latin America +1 800-578-9619

Mexico +001 800 578 9619



[www.logitech.com](http://www.logitech.com)

USB Wireless Nano Receiver Regulatory Information

Model #: A-00032

IC: 1807D-A00032

Made in China

Fabriqu e in Chine



  2011 Logitech. All rights reserved. Logitech, the Logitech logo, and other Logitech marks are owned by Logitech and may be registered. Microsoft, Windows, Windows Media Player, and the Windows logo are trademarks of the Microsoft group of companies. Mac, the Mac logo, and iTunes are trademarks of Apple Inc., registered in the U.S. and other countries. All other trademarks are the property of their respective owners. Logitech assumes no responsibility for any errors that may appear in this manual. Information contained herein is subject to change without notice.

**620-003302.003**