

WorkForce WF-2010W

DATASHEET / BROCHURE



The ideal single-function printer for small offices, which features Wi-Fi and Ethernet connectivity and individual XL inks

This single-function printer has a compact design with a small footprint. It can be placed almost anywhere within a small office or home office environment, and is robust and durable for important business documents.

The WorkForce WF-2010W uses Epson's fast drying DURABrite Ultra Ink for professional-quality business documents and means that prints are water, smudge and highlighter resistant. Cartridges are also available in XL size, helping to save further on costs, as users can print up to 2.5x more pages*1.

This printer also has flexible connectivity options, as users can connect the printer to their office network via Wi-Fi or Ethernet. With automatic Wi-Fi set-up, users don't need to know their network settings or connect with a USB cable during set up, as the printer automatically finds the relevant connection settings in order to configure itself*2.

The WorkForce WF-2010W comes with a robust 100-sheet rear paper tray, providing media flexibility for a variety of paper.

KEY FEATURES

- **Flexible**
Wi-Fi and Ethernet connectivity
- **Space saving**
Compact footprint
- **Economical**
Print more pages with Epson XL inks*1
- **Durable**
3,000 page duty cycle per month

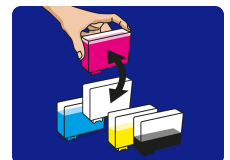

PRODUCT SPECIFICATIONS

TECHNOLOGY

Printing Method	4-colour inkjet printer
Minimum Droplet Size	3 pl, With Variable-Sized Droplet Technology
Ink Technology	DURABrite™ Ultra
Nozzle Configuration	180 Nozzles black, 59 Nozzles per colour
Application	Home Office, Office Desktop
All-in-One Functions	Print

PRINT

Printing Speed ISO/IEC 24734	9 pages/min Monochrome, 4.7 pages/min Colour
Maximum Printing Speed	34 pages/min Monochrome (plain paper), 18 pages/min Colour (plain paper), 38 Seconds per 10 x 15 cm photo (Epson Premium Glossy Photo Paper)
Printing Resolution	5,760 x 1,440 dpi
Max Duty cycle	3,000 pages per month
	The maximum number of printed pages per month based on the performance capabilities of the printer, including ISO rated print speeds and paper handling capabilities.
Colours	Black, Cyan, Yellow, Magenta
For detailed information on printing speeds please visit http://www.epson.eu/testing .	

PAPER / MEDIA HANDLING

Paper Formats	A4, A5, A6, B5, C6 (Envelope), 10 x 15 cm, 13 x 18 cm, 16:9, Letter, Letter Legal, DL (Envelope), No. 10 (Envelope), User defined
Duplex	Manual
Paper Tray Capacity	100 Sheets Standard, 100 Sheets maximum, 20 Photo Sheets
Number of paper trays	1

CONNECTIVITY

Interfaces	USB 2.0 Type B, Ethernet interface (100 Base-TX / 10 Base-T), USB 2.0 Type A, Wireless LAN IEEE 802.11b/g/n (WiFi 4)
WLAN Security	WEP 64 Bit, WEP 128 Bit, WPA PSK (TKIP), WPA PSK (AES)

GENERAL

Energy Use	2 W (sleep mode), 12 W (printing)
Product dimensions	392 x 264 x 148 mm (Width x Depth x Height)
Product weight	3.2 kg
Noise Level	51 B (A) according to ISO 7779 pattern with Epson Premium Glossy Photo Paper / Photo RPM mode - 36 dB (A) according to ISO 9296
Compatible Operating Systems	Mac OS 10.5.8 or later, Windows 10, Windows 7, Windows 7 x64, Windows 8, Windows Vista, Windows Vista x64, Windows XP, Windows XP x64
Recommended number of users	From 1 to 2

OTHER

Warranty	12 months Carry in Optional warranty extension available
----------	-------------------------------------------------------------

LOGISTICS INFORMATION

SKU	C11CC40301
EAN code	8715946517070
Country of Origin	Indonesia
Layer	5 Units
Layer Block	6 Units



For more information please contact:

Home users: 0343 90 37766
 Business users*: 0871 42 37766
 Republic of Ireland: 01 436 7742
 Or visit us at <https://www.epson.co.uk/contactus>
 * 10p per minute plus network extras.

Web: www.epson.co.uk
www.epson.ie

Trademarks and registered trademarks are the property of Seiko Epson Corporation or their respective owners.
 Product information is subject to change without prior notice.
 Last extracted: 2019-03-13

WorkForce WF-2010W

WHAT'S IN THE BOX

- Main unit
- Individual Ink Cartridges
- Wi-Fi/network setup guide
- User manual (CD)
- Software (CD)
- Warranty document
- Power cable

INK CARTRIDGE COMPATIBILITY



INK YIELD DATA



Pen and crossword 16 Pen and crossword 16XL

●	175 pages*	500 pages*
● ● ●	165 pages*	450 pages*

* Approx. page yield based on ISO/IEC 24711/24712 or ISO/IEC 29102/29103. Actual yield will vary depending on images printed and usage conditions. For more information visit <http://www.epson.eu/pageyield>

1. For more information, please visit www.epson.eu/inkjetsaving

EPSON®